



## BUCKET ELEVATOR or LOWERATOR OVERLAPPING BUCKET CONVEYOR

### 'X' SERIES

(SANITARY SOLID WALL  
FRAME CONSTRUCTION)

IMPERIAL DIMENSIONS

#### Used For

- Candy
- Cereals
- Chemicals
- Coffee
- Confectionery
- Detergents
- Dry Food
- Fertilizer
- Flour
- Hardware
- Insecticides
- Metal Scraps & Chips
- Pasta/Macaroni
- Pet Food
- Pharmaceutical
- Plastic Granules
- Potato Chips
- Powders
- Rice
- Seed
- Shelled Nuts
- Small Machine Parts
- Snacks
- Soaps
- Toys
- Vegetables

Other Dry or  
Semi-Dry Products

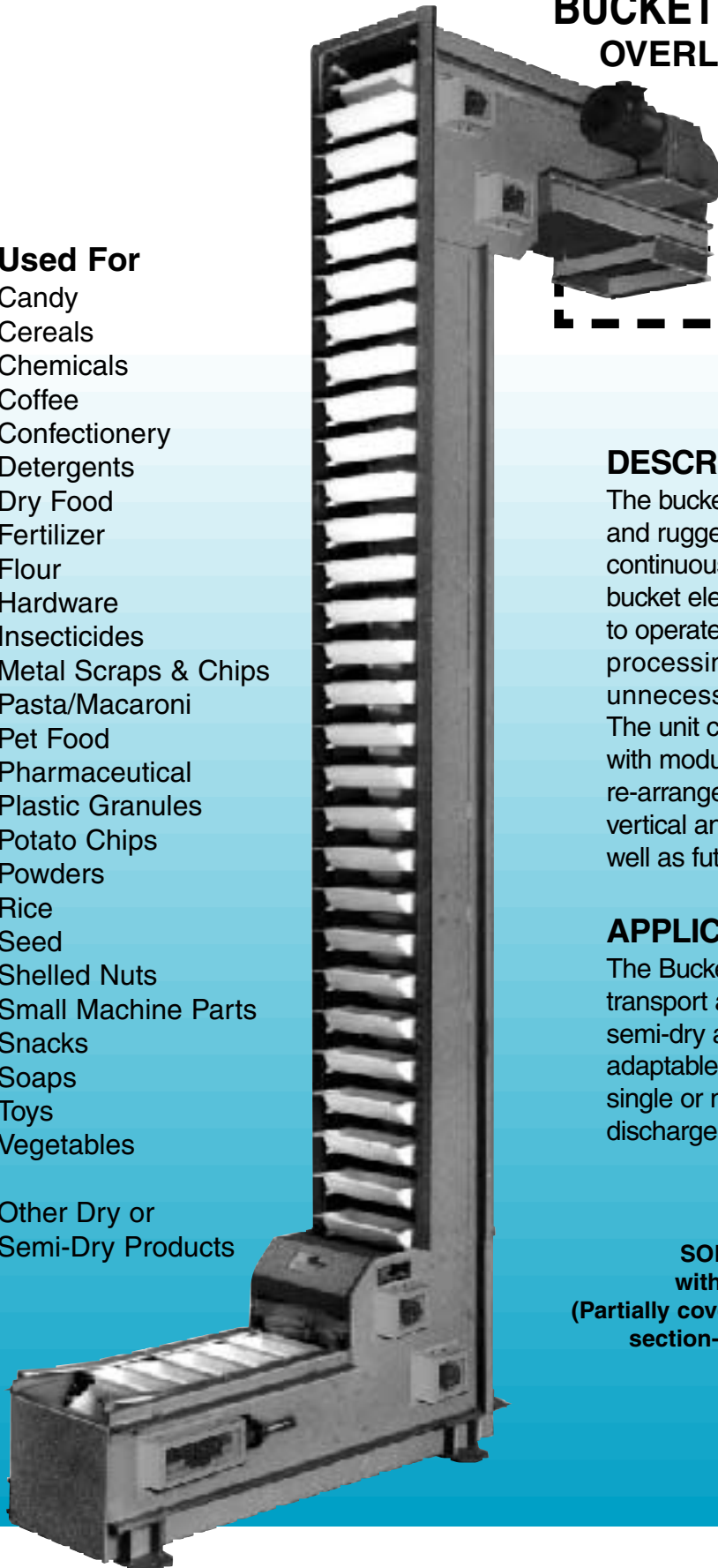

#### DESCRIPTION

The bucket Elevator/Lowerator unit is an engineered and ruggedly manufactured conveying system for continuous and quiet operation. The overlapping bucket elevator is versatile in material handling, simple to operate and capable of automating your complex processing needs, saving floor space and unnecessary pit requirements.

The unit construction is of a sanitary solid plate with modular sections, making it possible for re-arrangement in extension or contraction of the vertical and horizontal runs for initial installation as well as future expansion

#### APPLICATION

The Bucket Elevator/Lowerator is designed to gently transport a variety of free flow bulk materials in dry, semi-dry and moist conditions. The unit is extremely adaptable to deliver product to multi locations from single or multi source of supply through its variety of discharge locations and stations.

**SOLID WALL FRAME CONSTRUCTION  
with Sani-Plas (Polypropylene) Buckets  
(Partially covered, bottom of base section-back of vertical  
section-top and bottom of head section shown)**

**DESIGN, ENGINEERING & ASSOCIATED MANUFACTURING COMPANY**

6520 East Washington Blvd., City of Commerce, CA 90040-1822

Toll free (800) 933-2620 or (888) 933-2620 • Phone (323) 890-1190 • Fax (323) 890-1139 • [www.deamco.com](http://www.deamco.com) • email: [deamco@deamco.com](mailto:deamco@deamco.com)

# BUCKET ELEVATORS / LOWERATORS SPECIFICATIONS AND DIMENSIONS FOR SOLID WALL FRAME OF 'X' SERIES

## ADVANTAGES - FEATURES

Frame	Sanitary solid wall construction meets USDA, FDA and other governmental standards. The construction lends itself to visual inspection, safety in operation, maintenance and easy access for cleaning.
Bearings	Sealed, lubricated, self aligning ball bearings.
Buckets	Standard and customized one piece buckets for every application. Heavy-duty one piece bucket available in: <ul style="list-style-type: none"><li>• 'Sani-Plas' (Polypropylene) FDA approved</li><li>• Stainless (sanitary finish)</li><li>• Carbon steel</li><li>• Cast aluminum alloy</li><li>• For customized bucket requirements, contact factory.</li></ul>
Sprockets	At all turns to reduce wear and tear on tracks and chains.
Carrier Chains	Special heavy duty designed chains (Available from a variety of materials and combinations.) Heavy-duty double pitch with oversize hardened rollers and prelubed bushings. Large rollers roll on tracks reducing friction, wear and power requirements. Chains available in: <ul style="list-style-type: none"><li>• Carbon steel with Delrin roller</li><li>• Carbon steel with Carbon steel rollers</li><li>• Stainless steel chain with Delrin roller</li><li>• Stainless steel with stainless steel roller</li><li>• For customized chain combinations, contact factory.</li></ul>
Guides	Suitable guides fabricated out of steel as well as other plastic materials to eliminate noise, wear and tear.
Motor & Drive	Gear head motor (right angle or straight); head or side mounted.
Safety Clutch	Adjustable torque limiter on drive shaft for adjustment of load and protection against jamming by foreign or internal malfunction.
Supports	Channel sanitary construction.
Covers	Suitable safety cover.
Installation	Units are factory assembled and tested prior to shipment. Larger units are disassembled and shipped in knock-down (KD) form due to shipping restrictions.

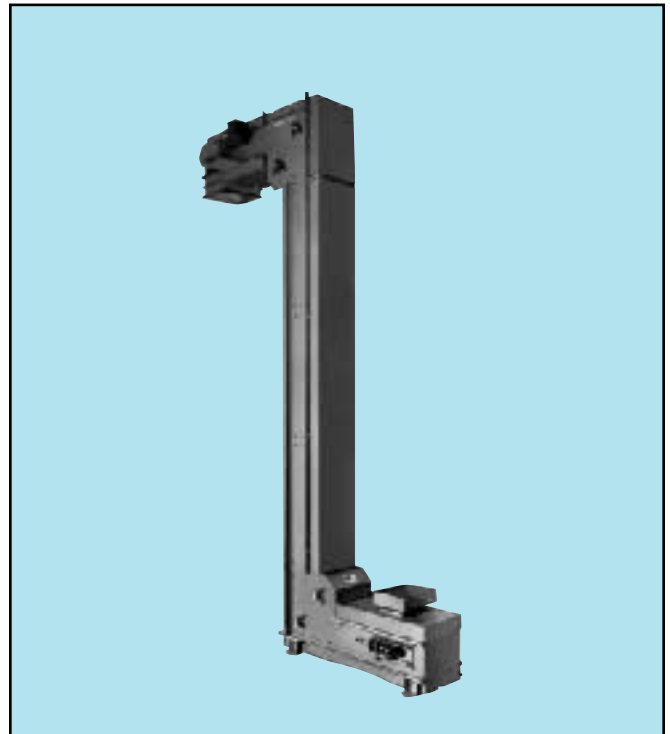

**SOLID WALL FRAME CONSTRUCTION**  
(Totally covered unit shown)

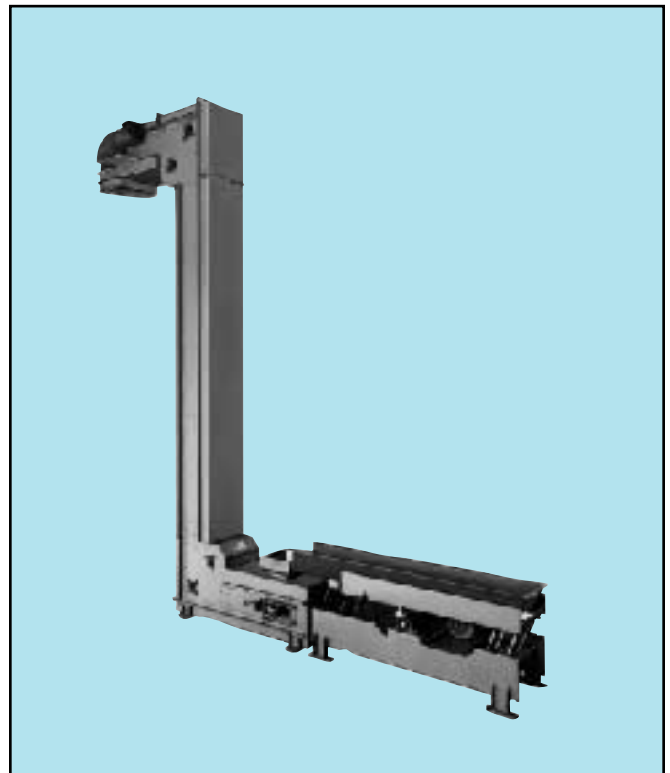

**SOLID WALL FRAME CONSTRUCTION**  
(Totally covered unit with  
DEAMCO Vibratory Conveyor/Feeder shown)

### DESIGN, ENGINEERING & ASSOCIATED MANUFACTURING COMPANY

6520 East Washington Blvd., City of Commerce, CA 90040-1822

Toll free (800) 933-2620 or (888) 933-2620 • Phone (323) 890-1190 • Fax (323) 890-1139 • www.deamco.com • email: deamco@deamco.com



**BER-36P-SW-X**  
(Fully covered)



**BER-42P-SW-X**



**BER-48S-SW-X**  
(Stainless steel buckets)

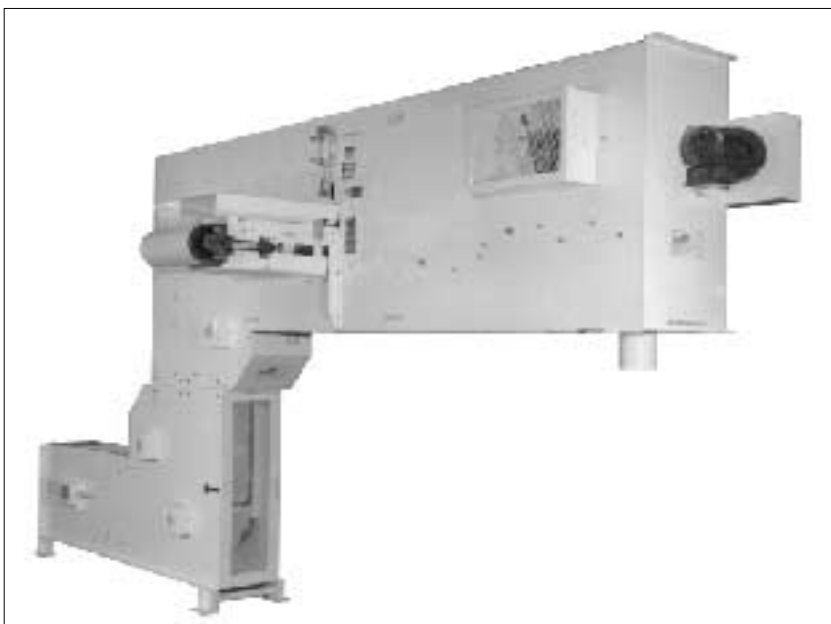

**BEH-12P-SW-X1**  
(Fully covered with conveyORIZED intermittent discharge)



**BEH-24S-SW-X**  
(Stainless steel buckets  
and dual discharge chute)

**DESIGN, ENGINEERING & ASSOCIATED MANUFACTURING COMPANY**

6520 East Washington Blvd., City of Commerce, CA 90040-1822

Toll free (800) 933-2620 or (888) 933-2620 • Phone (323) 890-1190 • Fax (323) 890-1139 • [www.deamco.com](http://www.deamco.com) • email: [deamco@deamco.com](mailto:deamco@deamco.com)

## BES or BLS Series-BUCKETS

MODEL	D	L	W	CAP CU. IN.
BES or BLS-6	2½	5¾	4½	50
BES or BLS-9	2½	8¾	4½	75
BES or BLS-12	2½	11¾	4½	100
BES or BLS-15	2½	14¾	4½	125
BES or BLS-18	2½	17¾	4½	150

## CARRIER CHAIN

MODEL	CHAIN SIZE	P	D
BES or BLS	C2052-D1	1¼	¾
BES or BLS	C2052-D1-OBR	1¼	¾

## BEM or BLM Series-BUCKETS

MODEL	D	L	W	CAP CU. IN.
BEM or BLM-9	4	8¾	8¾	210
BEM or BLM-12	4	11¾	8¾	290
BEM or BLM-15	4	14¾	8¾	365
BEM or BLM-18	4	17¾	8¾	445
BEM or BLM-24	4	23¾	8¾	600

## CARRIER CHAIN

MODEL	CHAIN SIZE	P	D
BEM or BLM	C2062H-D1	1½	7/8

## BEH or BLH Series-BUCKETS

MODEL	D	L	W	CAP CU. IN.
BEH or BLH-9	5¼	8	10¾	340
BEH or BLH-12	5¼	11	10¾	470
BEH or BLH-15	5¼	14	10¾	600
BEH or BLH-18	5¼	17	10¾	725
BEH or BLH-24	5¼	23	10¾	980
BEH or BLH-30	5¼	29	10¾	1240
BEH or BLH-36	5¼	35	10¾	1495
BEH or BLH-48	5¼	47	10¾	2005

## CARRIER CHAIN

MODEL	CHAIN SIZE	P	D
BEH or BLH	C2082H-D1	2	1⅝

## BER or BLR Series-BUCKETS

MODEL	D	L	W	CAP CU. IN.
BER or BLR-36	7¾	34¼	16	3230
BER or BLR-42	7¾	40¼	16	3795
BER or BLR-48	7¾	46¼	16	4360

## CARRIER CHAIN

MODEL	CHAIN SIZE	P	D
BER or BLR	C2122H-D1	3	1¾

## CARRIER BUCKETS AND CHAINS

BES SERIES SHOWN

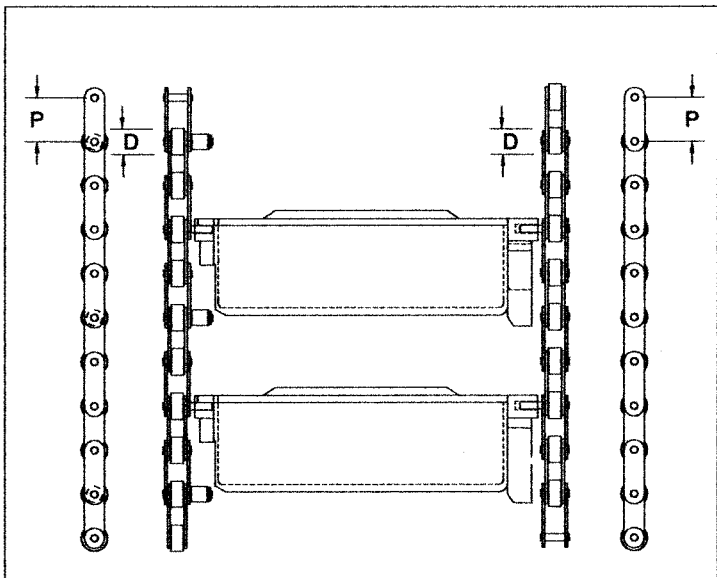
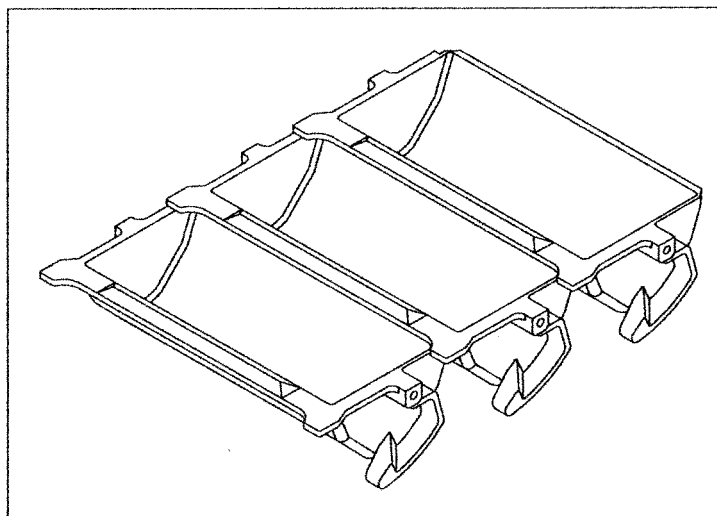
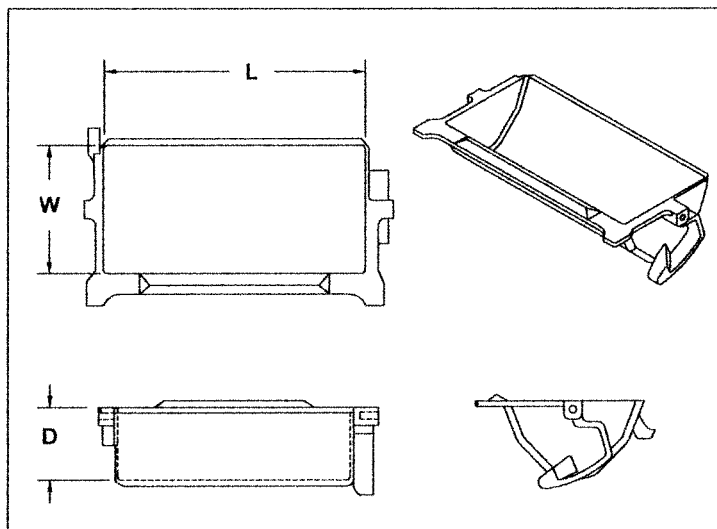

•Dimensions shown are in inches.

**DESIGN, ENGINEERING & ASSOCIATED MANUFACTURING COMPANY**

6520 East Washington Blvd., City of Commerce, CA 90040-1822

Toll free (800) 933-2620 or (888) 933-2620 • Phone (323) 890-1190 • Fax (323) 890-1139 • www.deamco.com • email: deamco@deamco.com

### BES or BLS 'X' Series (Solid Wall Frame Construction)

CU/FT/HR MODEL	BUCKETS 100%	BUCKETS 75%	BUCKETS * 75%	A I/D MIN.	A I/D MIN.	B MIN.	C	D	E	F	G	H	I	J	K	L	M	N	N I/D MIN.	P	R	S	T	V	W	SHIP WEIGHT
BES or BLS-6	260	195	145	42	69	10	42	10	9	10	3	35	11	16	6	10	3	21	48	12	11	35	34	13	27	38#/FT
BES or BLS-9	390	295	220	42	71	10	42	13	12	10	3	35	11	16	9	10	3	21	50	12	11	37	34	15	27	40#/FT
BES or BLS-12	520	390	295	42	83	10	42	16	15	10	3	35	11	16	12	10	3	21	62	12	11	49	34	17	27	41#/FT
BES or BLS-15	650	490	370	42	86	10	42	19	18	10	3	35	11	16	15	10	3	21	65	12	11	52	34	19	27	43#/FT
BES or BLS-18	780	585	440	42	90	10	42	22	21	10	3	35	11	16	18	10	3	21	69	12	11	56	34	21	27	49#/FT

Sizes = Inches

Capacity = Cubic foot per hour

For intermediate discharges do not exceed 150 buckets per minute

**CHAIN SPEED:**

60 Foot per minute

70 Foot per minute maximum

**BUCKET SPEEDS:**

150 Buckets per minute standard

175 Buckets per minute maximum

\* 'C' Configuration Requirements

• To above shipping weights add approximately 700 pounds per elevator for drive, sprockets, chain and related items.

### BEM or BLM 'X' Series (Solid Wall Frame Construction)

CU/FT/HR MODEL	BUCKETS 100%	BUCKETS 75%	BUCKETS * 75%	A I/D MIN.	A I/D MIN.	B MIN.	C	D	E	F	G	H	I	J	K	L	M	N	N I/D MIN.	P	R	S	T	V	W	SHIP WEIGHT
BEM or BLM-9	800	600	450	60	111	12	60	15	9	14	5	50	19	20	6	11	5	30	81	16	16	63	48	20	40	41#/FT
BEM or BLM-12	1110	830	620	60	114	12	60	18	12	14	5	50	19	20	9	11	5	30	84	16	16	66	48	22	40	43#/FT
BEM or BLM-15	1395	1045	785	60	117	12	60	21	15	14	5	50	19	20	12	11	5	30	87	16	16	69	48	24	40	44#/FT
BEM or BLM-18	1700	1275	955	60	120	12	60	24	18	14	5	50	19	20	15	11	5	30	90	16	16	72	48	26	40	46#/FT
BEM or BLM-24	2290	1720	1290	60	126	12	60	30	24	14	5	50	19	20	21	11	5	30	96	16	16	78	48	29	40	52#/FT

Sizes = Inches

Capacity = Cubic foot per hour

For intermediate discharges do not exceed 110 buckets per minute

**CHAIN SPEED:**

80 Foot per minute

95 Foot per minute maximum

**BUCKET SPEEDS:**

110 Buckets per minute standard

130 Buckets per minute maximum

\* 'C' Configuration Requirements

• To above shipping weights add approximately 750 pounds per elevator for drive, sprockets, chain and related items.

### BEH or BLH 'X' Series (Solid Wall Frame Construction)

CU/FT/HR MODEL	BUCKETS 100%	BUCKETS 75%	BUCKETS * 75%	A I/D MIN.	A I/D MIN.	B MIN.	C	D	E	F	G	H	I	J	K	L	M	N	N I/D MIN.	P	R	S	T	V	W	SHIP WEIGHT
BEH or BLH-9	825	620	465	72	137	14	72	15	9	16	8	66	16	27	6	20	6	36	101	18	20	80	57	26	44	87#/FT
BEH or BLH-12	1140	855	640	72	143	14	72	18	12	16	8	66	16	27	9	20	6	36	107	18	20	86	57	28	44	92#/FT
BEH or BLH-15	1460	1095	820	72	144	14	72	21	15	16	8	66	16	27	12	20	6	36	108	18	20	87	57	30	44	95#/FT
BEH or BLH-18	1760	1320	990	72	147	14	72	24	18	16	8	66	16	27	15	20	6	36	111	18	20	90	57	32	44	99#/FT
BEH or BLH-24	2380	1785	1340	72	153	14	72	30	24	16	8	66	16	27	21	20	6	36	117	18	20	96	57	36	44	107#/FT
BEH or BLH-30	3015	2260	1695	72	159	14	72	36	30	16	8	66	16	27	27	20	6	36	123	18	20	102	57	40	44	115#/FT
BEH or BLH-36	3635	2725	2045	72	165	14	72	42	36	16	8	66	16	27	33	20	6	36	128	18	20	108	57	44	44	123#/FT
BEH or BLH-48	4870	3650	2740	72	177	14	72	54	48	16	8	66	16	27	45	20	6	36	141	18	20	120	57	46	44	132#/FT

Sizes = Inches

Capacity = Cubic foot per hour

For intermediate discharges do not exceed 70 buckets per minute

**CHAIN SPEED:**

70 Foot per minute

80 Foot per minute maximum

**BUCKET SPEEDS:**

70 Buckets per minute standard

80 Buckets per minute maximum

\* 'C' Configuration Requirements

• To above shipping weights add approximately 800 pounds per elevator for drive, sprockets, chain and related items.

### BER or BLR 'X' Series (Solid Wall Frame Construction)

CU/FT/HR MODEL	BUCKETS 100%	BUCKETS 75%	BUCKETS * 75%	A I/D MIN.	A I/D MIN.	B MIN.	C	D	E	F	G	H	I	J	K	L	M	N	N I/D MIN.	P	R	S	T	V	W	SHIP WEIGHT
BER or BLR-36	6730	5050	3790	108	202	21	108	45	39	23	10	94	30	35	35	24	14	54	148	24	31	121	81	44	54	180#/FT
BER or BLR-42	7910	5930	4450	108	206	21	108	51	45	23	10	94	30	35	41	24	14	54	152	24	31	125	81	46	54	185#/FT
BER or BLR-48	9080	6810	5110	108	210	21	108	57	51	23	10	94	30	35	47	24	14	54	156	24	31	129	81	48	54	190#/FT

Sizes = Inches

Capacity = Cubic foot per hour

For intermediate discharges do not exceed 60 buckets per minute

**CHAIN SPEED:**

90 Foot per minute

103 Foot per minute maximum

**BUCKET SPEEDS:**

60 Buckets per minute standard

69 Buckets per minute maximum

\* 'C' Configuration Requirements

• To above shipping weights add approximately 1,000 pounds per elevator for drive, sprockets, chain and related items.

• Specifications are subject to change without notice.

#### DESIGN, ENGINEERING & ASSOCIATED MANUFACTURING COMPANY





# SOLID WALL FRAME CONSTRUCTION SHOWN

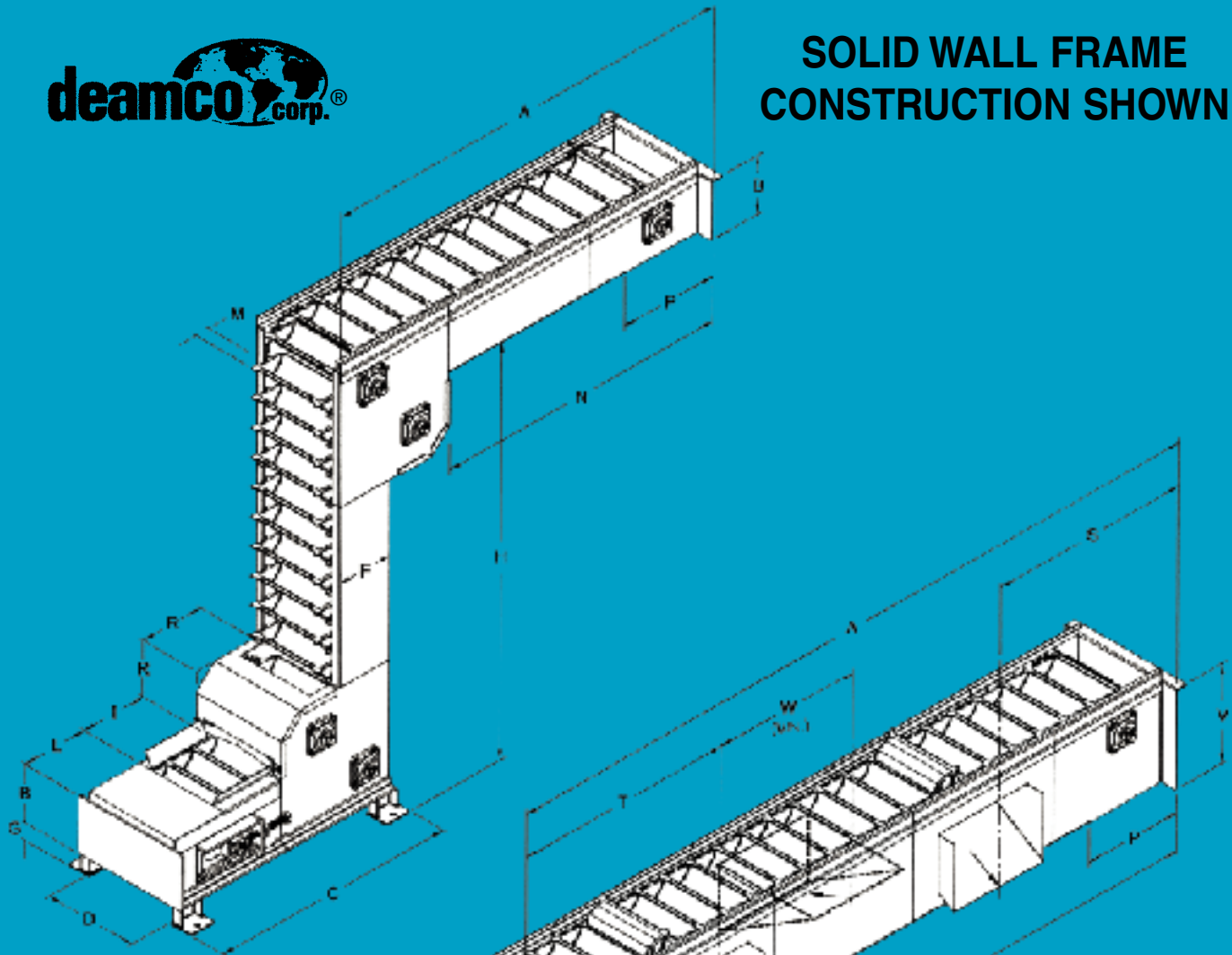

**TOTAL VIEW**

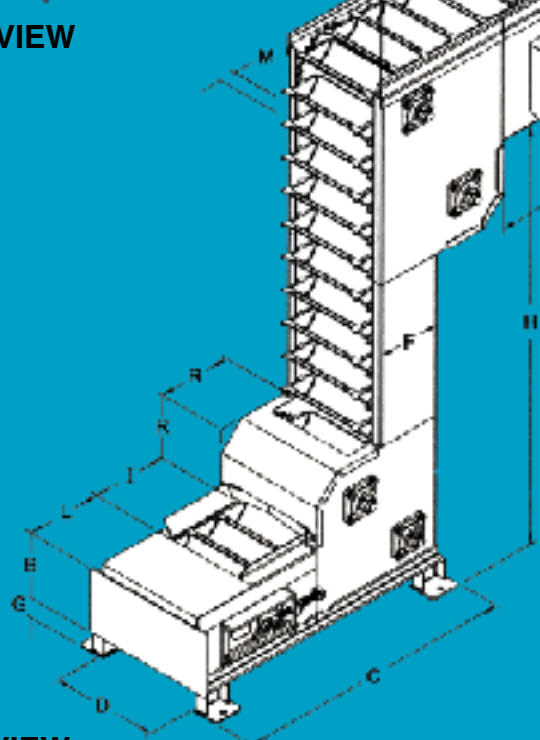

**TOTAL VIEW**

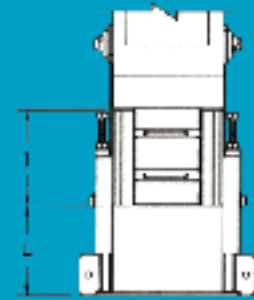

**INFEED TOP VIEW**

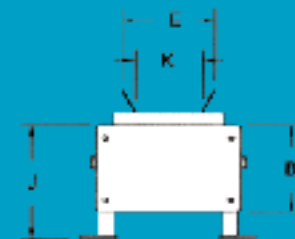

**INFEED END VIEW**

**DESIGN, ENGINEERING & ASSOCIATED MANUFACTURING COMPANY**

6520 East Washington Blvd., City of Commerce, CA 90040-1822

Toll free (800) 933-2620 or (888) 933-2620 • Phone (323) 890-1190 • Fax (323) 890-1139 • [www.deamco.com](http://www.deamco.com) • email: [deamco@deamco.com](mailto:deamco@deamco.com)

# Bucket Elevator/Lowerator – ‘X’ Series

BES/BLS • BEM/BLM • BEH/BLH • BER/BLR

(SANITARY SOLID WALL FRAME CONSTRUCTION)

## OPTIONS

- Stainless steel construction
- Totally enclosed construction
- Completely sealed tight construction
- Other locations for motor and drive mounting
- Vari-Drive unit
- Electrical control panel
- Air control panel for discharge stations
- Centralized lubrication system
- Variety of inlet and discharge stations (end, side, bottom and other customized forms of inlets and discharges)
- \_\_\_\_\_
- \_\_\_\_\_

## CUSTOMIZED CONFIGURATIONS

(Other variations also available)

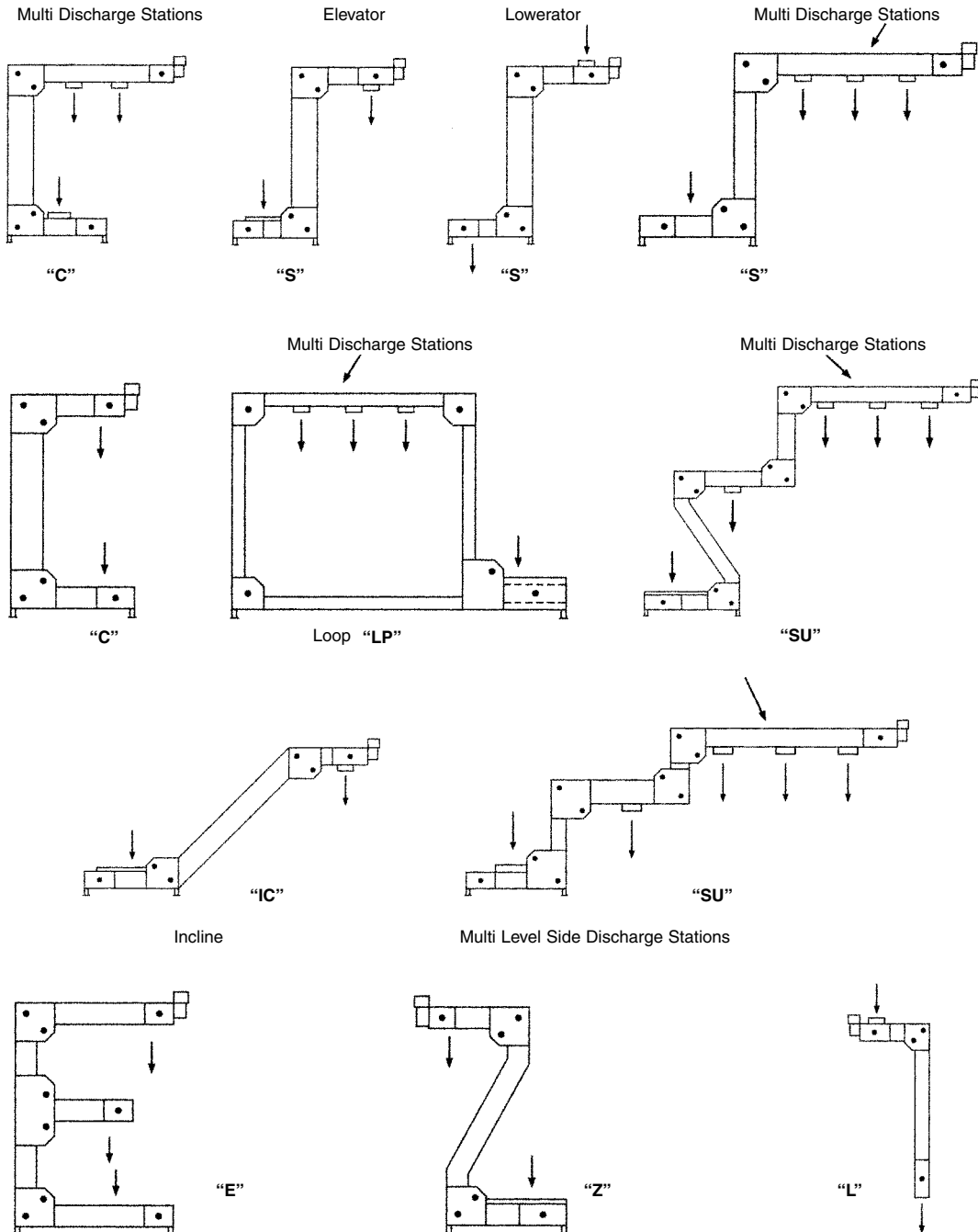

**DESIGN, ENGINEERING & ASSOCIATED MANUFACTURING COMPANY**

6520 East Washington Blvd., City of Commerce, CA 90040-1822

Toll free (800) 933-2620 or (888) 933-2620 • Phone (323) 890-1190 • Fax (323) 890-1139 • www.deamco.com • email: deamco@deamco.com

**Bucket Elevator/Lowerator – ‘X’ Series**  
**BES/BLS • BEM/BLM • BEH/BLH • BER/BLR**  
**(SANITARY SOLID WALL FRAME CONSTRUCTION)**

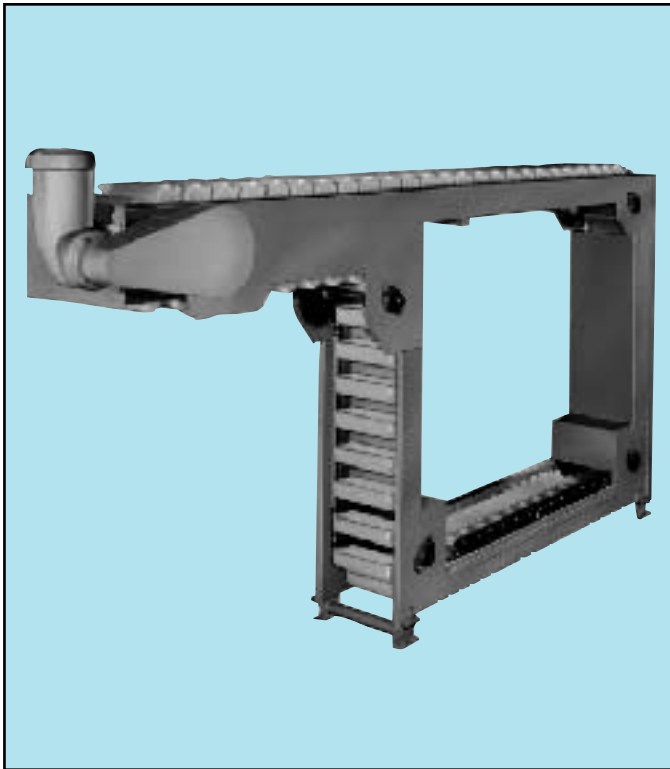

**MODEL BES-12P-SW BUCKET ELEVATOR**  
**LOOP CONFIGURATION SHOWN**  
**(IDEAL FOR LOW LEVEL FEED APPLICATIONS)**

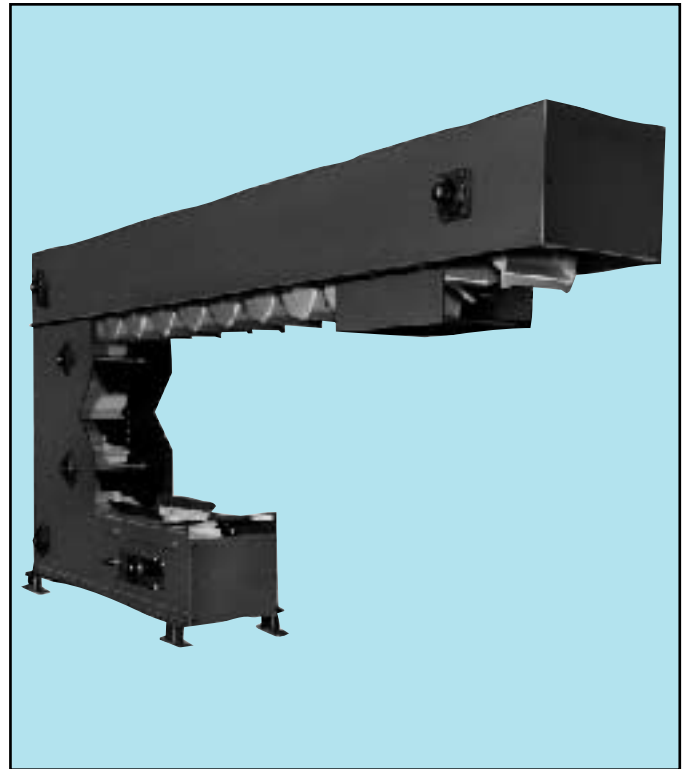

**MODEL BEH-12P-SW BUCKET ELEVATOR**  
**“C” CONFIGURATION SHOWN**

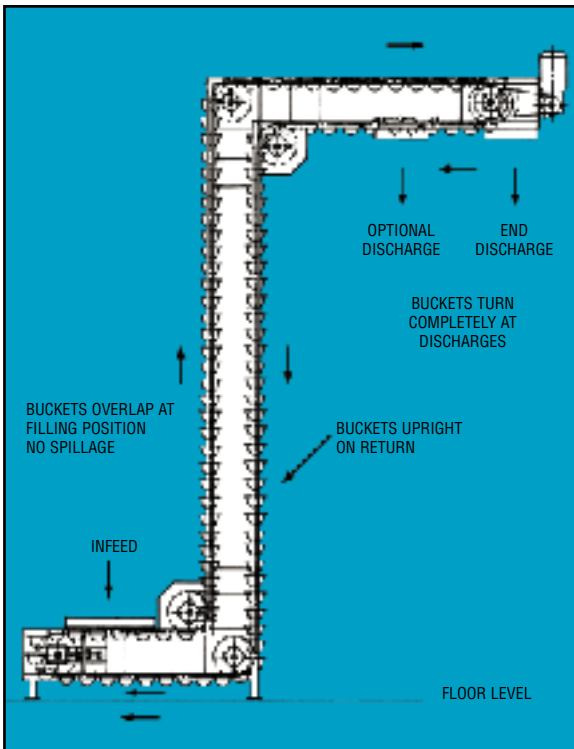

**BES-BU and BLS-BU**  
**BUCKET-UPRIGHT SERIES**  
**(TUBULAR FRAME SHOWN)**

When your requirements are submitted to DEAMCO, you immediately have the benefit of global expertise gained by DEAMCO from the design and construction of many similar projects.



**Contact DEAMCO for other equipment as well as your material handling and processing needs.**

Deamco Corp. Ltd.  
 829 yeovil Road, Trading Estate  
 Slough, Berks England SL1 4JA  
 Tel: 01753533513  
 Fax: 07153533514

Sturton-Gill Engineering  
 7 Holloway Drive  
 Bayswater, Victoria, Australia 3153  
 Tel: 011-61-3-9762-8800  
 Fax: 011-61-3-9762-8278

**DESIGN, ENGINEERING & ASSOCIATED MANUFACTURING COMPANY**  
 6520 East Washington Blvd., City of Commerce, CA 90040-1822

**2002**  
 Bulletin # 050502